

Pro

ProLamp 1017B/ml



FEATURES

- Base designed for permanent mounting, hardware included.
- Robust base with a dark bronze finish.
- Decorative appearance with a polished marine brass center column.
- Eight foot cord, plug and double pole switch provided.

APPLICATIONS

- Marine interior
- Cruise ships/commercial ferries
- Cabin lighting
- Table/desk lighting

APPROVALS

- Conforms to IP20
- Marine Inside Type
- ABS

TECHNICAL SPECIFICATIONS

BASE

Steel with an electrostatically applied dark bronze polyester powder coat finish.

CENTER COLUMN

Marine brass, polished with a clear coat protective finish.

MOUNTING

Designed for table or desk with 1/4" threaded pipe and lock nuts to facilitate permanent mounting.

LAMP HOLDER

Medium base.

LAMP TYPE

Suitable for use with a 150w A-21 max. Lamp not provided.

SHADE

White polyplastic.

SWITCH

Rocker type, double pole.

CORD AND PLUG

8 foot cord with a NEMA 5-15P plug.

VOLTAGE

Rated to 120v.

ORDERING REFERENCES

PART NUMBER	DESCRIPTION	NO. LAMPS	WEIGHT LBS
1017B	Table Lamp	A-21 150w max	4.0

SPARE PARTS

Part No.	Description
INX3526	LAMP, 60w
INX3528	LAMP, 100w
INX3543	LAMP, 150w
INX4009	LAMP HOLDER
INX3378	SWITCH
INX8146	SHADE

DIMENSIONS

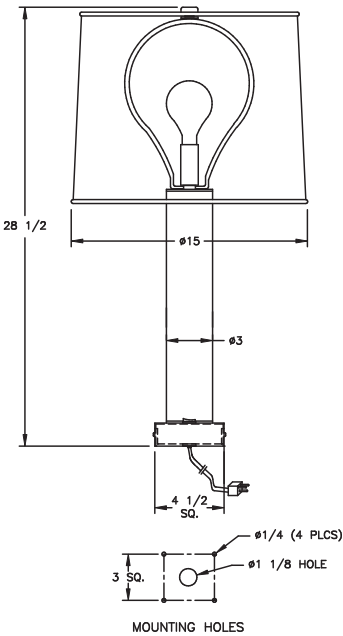

Dimensions in inches