

Pro

ProXchange 2400/mw



FEATURES

- Weatherproof toggle switch.
- Cover may be locked closed to limit accessibility.
- Wide range of switch types in single pole, double pole, three way or four way units.
- Heavy duty mounting pads.
- Silicone lubricant provided for cover screws and flange.
- Neoprene gasket resists petroleum and provides a watertight seal.
- Wide range of switch types in single pole, double pole, three way or four way units.
- Switches rated at 15, 20 or 30 Amp.

APPLICATION

- Damp or wet locations

APPROVALS

- Conforms to IP52
- ABS

TECHNICAL SPECIFICATIONS

BOX

Cast copper free aluminum.

COVER

Die cast aluminum, powder coated.

HARDWARE

Stainless steel.

GASKET

One piece neoprene.

ENTRIES

Standard units undrilled. Up to four 1" NPT outlets available. See ENTRY OPTIONS for selections.

VOLTAGE AND CURRENT

SWITCH

15 Amp, 277v AC
20 Amp, 250v AC
30 Amp, 250v AC

MOUNTING

Surface, via two maximum 1/4" mounting bolts (not included).

ORDERING REFERENCES

PART NUMBER	DESCRIPTION	VOLTAGE AND CURRENT	WEIGHT LBS
2420A	Single Pole	15A 277v AC	1.8
2430A	Single Pole	20A 250v AC	1.8
2440A	Single Pole	30A 250v AC	1.8
2422A	Double Pole	15A 277v AC	1.8
2432A	Double Pole	20A 250v AC	1.8
2442A	Double Pole	30A 250v AC	1.8
2423A	Three Way	15A 277v AC	1.8
2433A	Three Way	20A 250v AC	1.8
2443A	Three Way	30A 250v AC	1.8
2424A	Four Way	15A 277v AC	1.8

ENTRY OPTIONS

NPT Trade Size	Dead End	Thru Feed	X-Positions
1/2"	E1	C1	X1
3/4"	E2	C2	X2
1"	E3	C3	X3

SPARE PARTS

Part No.	Description	Part No.	Description
INX6548A	COVER & GASKET	INX3038	DOUBLE POLE SWITCH, 20 Amp 250v AC
INX6030A	BOX	INX3008	DOUBLE POLE SWITCH, 30 Amp 250v AC
INX3034	SINGLE POLE SWITCH, 15 Amp 277v AC	INX3040	THREE WAY SWITCH, 15 Amp 277v AC
INX3025	SINGLE POLE SWITCH, 20 Amp 250v AC	INX3041	THREE WAY SWITCH, 20 Amp 250v AC
INX3026	SINGLE POLE SWITCH, 30 Amp 250v AC	INX3042	THREE WAY SWITCH, 30 Amp 250v AC
INX3002	DOUBLE POLE SWITCH, 15 Amp 277v AC	INX3009	FOUR WAY SWITCH 15 Amp 277v AC

DIMENSIONS

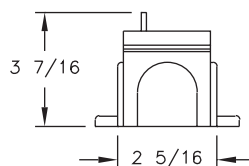
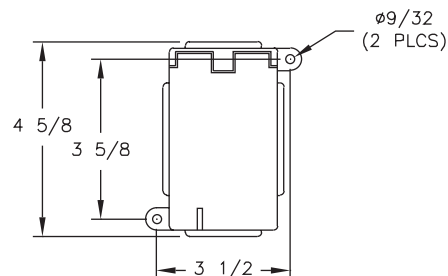

Dimensions in inches

2420A-2424A / 2430A-2433A
2440A-2443A